



GREECE ADVENTURE 2020

Waterfront Property Newsletter

In this issue:

- Itinerary for Trip
- A very high level estimation of costs at this time (subject to change)
- Boat Crews
- Boat Configuration
- Useful Links
- Location on map

Welcome

Thank you all for participating in the Greece Adventure 2020. We are delighted you have decided to join us and be a part of the most amazing trip to Greece. We hope that you will all enjoy this as much as we have in the past.

— John and Pat Kalfa

Current Trip Itinerary

June 12 — Stay by Marina

June 13th — Arrive at dock (ISTION Yachting) in the morning for provisioning (suggesting 9 am currently)

June 13th — Leave dock 5 pm sharp

Day	Port	Distance
1	Lefkas Port	
2	Palairos	11
3	Kalamos	16
4	Kastos	5
5	Sivota	13
6	Meganisi	8
7	Lefkas Port	11
Total Distance:		64

June 19th — Return to dock

June 20th — disembark 9 am

June 20th — Start journey back home.

Boat 1 Crew

Donna Agati
 Peter Agati
 Lance Smith
 Christine Smith
 Vicky Lezaca
 Scott Burns (Tent.)
 Pat Kalfa
 John Kalfa

Boat 2 Crew

Rob Kenerg
 Michaoz Coyle
 Elyn Coyle
 Rob Feihel
 Jayne Feihel
 Jan Heinlein
 Mary Anne Mc Cruden
 Katrina Xenos

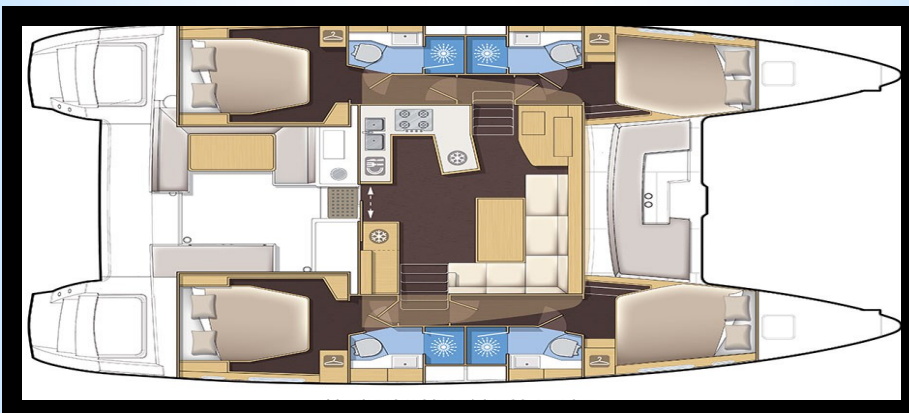

Boat Configuration



GREECE ADVENTURE 2020

Waterfront Property Newsletter

In this issue:

- Itinerary for Trip
- Boat Crews
- Boat Configuration
- Useful Links
- Location on map

Useful Links:

Istion Charter Company

- ⇒ www.istion.com
- ⇒ The Quay, Vliho, Lefkas, 31084 Greece

Master Captain Ins.

- ⇒ www.pantaenius.com/de-en/insurance/charter

Travel Insurance

- ⇒ www.travelguard.com/aig/travelinsurance
- ⇒ www.allianztravelinsurance.com/TravelInsurance/BuyOnline
- ⇒ www.travelinsurance.com

Hotels

- ⇒ In Athens — <https://www.electrahotels.gr/en/athens/electra-athens/>
- ⇒ In Lefkas — <https://www.google.com/search?client=firefox-b-1-d&q=Hotels+Near+The+Quay%2C+Vliho%2C+Lefkas%2C+31084+Greece>

